



3 bed semi-detached house to buy in TS28

Newholme Estate, Station Town, Wingate, Durham, TS28 5EJ

£89,000

🏠 x3 🚗 x2 🚻 x1

Tenure

Freehold

Property features

- ✓ Three Bedrooms Semi-Detached
- ✓ No Onward Chain
- ✓ Driveway
- ✓ Ideal Investment Opportunity
- ✓ EPC Rating D

Driveway parking

Garden

Key Information

- ✓ Council Tax: Band A
- ✓ EPC Rating: D
- ✓ Heating supply: Gas

Description

Three-bedroom semi-detached property situated on Newholme Estate, Wingate.

WALK THROUGH VIDEO TOUR AVAILABLE

The property briefly comprises: Hallway leading to the lounge, kitchen/dining area, down stairs W/C and a utility room. Three double bedroom and family bathroom are located on first floor.

Externally the property offers a driveway with ample parking to the front elevation. Fully enclosed large well presented garden with patio and deck area for low maintenance.

This property is an excellent choice for those seeking a comfortable and well-equipped home. Don't miss the opportunity to make this property your own. For any further information or to book your internal viewing please call Pattinson on 0191 5183521.

Council Tax Band: A

Tenure: Freehold

Price: £89,000

Property Type: Semi-detached house

USPs: Garden

Parking: Driveway

Heating: Gas

External Front

Access via double gate, paved driveway, ample parking space and low maintenance.



Entrance Way

2.70m x 1.00m (8'10" x 3'3")

Access via UVPC door, radiator and tiled flooring.



Living Room

4.50m x 3.50m (14'9" x 11'5")

Double glazed window to the front elevation, tv point, radiator and carpet.



Kitchen

4.40m x 3.50m (14'5" x 11'5")

Double glazed window to the rear elevation, range of wall and base units with contrasting work surfaces, sink and drainer unit, 5 burner gas hob with wok burner, stainless steel splash back, fan oven, built in fridge, freezer and laminate flooring.



Dining Area

4.40m x 3.50m (14'5" x 11'5")

Adjoining the kitchen, radiator and laminate flooring.



W/C

1.30m x 1.10m (4'3" x 3'7")

Double glazed window to the side elevation, low level WC and laminate flooring.



Utility Room

2.30m x 0.80m (7'6" x 2'7")

Double glazed window to the side elevation, plumbed for a washing machine and laminate flooring.



Bedroom 1

3.60m x 2.60m (11'9" x 8'6")

Double glazed window to the front elevation, radiator and carpet.



Bedroom 2

3.60m x 2.50m (11'9" x 8'2")

Double glazed window to the rear elevation, radiator and carpet.



Bedroom 3

2.50m x 1.90m (8'2" x 6'2")

Double glazed window to the side elevation, radiator and carpet.



Bathroom

1.90m x 1.80m (6'2" x 5'10")

Double glazed window to the rear elevation, three piece suite comprising; low level w/c, vanity wash basin with stainless steel mixer tap, walk in shower, radiator and marble flooring.



External Rear

Fully enclosed large garden, with grassed, stoned and split level decking for low maintenance.





Ground Floor

Floor area 53.8 sq.m. (580 sq.ft.)

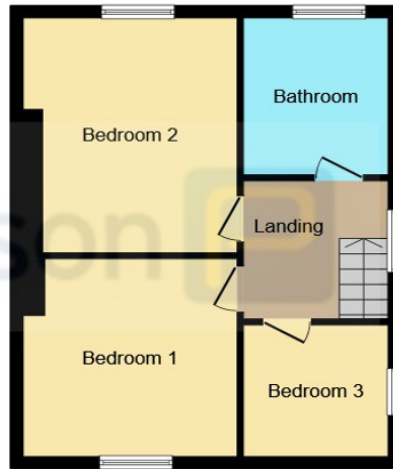

First Floor

Floor area 45.1 sq.m. (485 sq.ft.)

TOTAL: 98.9 sq.m. (1,065 sq.ft.)

This floor plan is for illustrative purposes only. It is not drawn to scale. Any measurements, floor areas (including any total floor area), openings and orientations are approximate. No details are guaranteed, they cannot be relied upon for any purpose and do not form any part of any agreement. No liability is taken for any error, omission or misstatement. A party must rely upon its own inspection(s). Powered by www.Propertybox.io

Energy Efficiency Rating		Current	Potential
<i>Very energy efficient - lower running costs</i>			
(92-100) A			
(81-91) B			
(69-80) C			79
(55-68) D		62	
(39-54) E			
(21-38) F			
(1-20) G			
<i>Not energy efficient - higher running costs</i>			
England, Scotland & Wales		EU Directive 2002/91/EC	

Newholme Estate, Station Town, Wingate, Durham, TS28 5EJ

Contact your local branch today for more information on this property:

**126A Trinity Street, Huddersfield, West Yorkshire, HD1 4DT, Tel: 01484 506211,
admin@yellowbrickroadestateagents.co.uk, www.ybrea.co.uk**

These particulars, whilst believed to be accurate are set out as a general outline only for guidance and do not constitute any part of an offer or contract. Intending purchasers should not rely on them as statements of representation of fact, but must satisfy themselves by inspection or otherwise as to their accuracy. No person in this firm's employment has the authority to make or give any representation or warranty in respect of the property.

