



## 2 bed semi-detached house to buy in DH8

Horton Close, Consett, Durham, DH8 7EN

**£145,000** Offers Over

🛏 x 2 🚿 x 3 🚗 x 1

Tenure

**Freehold**

Driveway parking

## Property features

- ✓ TWO SEPERATE EN-SUITES
- ✓ JUILLET BALCONEY
- ✓ KITCHEN/LOUNGE
- ✓ DOUBLE GLAZED & GAS CENTRAL HEATING
- ✓ EPC Rating C

## Key Information

- ✓ Council Tax: Band B
- ✓ EPC Rating: C
- ✓ Heating supply: Gas

## Description

Located in a quiet and desirable cul-de-sac within Delves Lane, this beautifully presented two-bedroom semi-detached home offers a fantastic opportunity for first-time buyers or couples seeking a modern and low-maintenance property in a convenient location.

The ground floor features a bright and spacious open-plan lounge and kitchen, creating a welcoming and sociable living area. The kitchen is well-equipped with modern appliances, while the lounge benefits from natural light and direct access to the south-facing private rear garden, perfect for relaxing or entertaining in the warmer months.

Upstairs, the property boasts two generously sized double bedrooms, both with their own en-suite facilities. The principal bedroom offers a touch of luxury with a Juliet balcony and fitted wardrobes, providing both style and functionality. The second bedroom also benefits from an en-suite, offering added comfort and privacy for guests or family members.

Additional features include a fully boarded loft with electric supply, ideal for storage or potential further use, and a gas central heating boiler.

Externally, the home includes a well-maintained rear garden and off-street parking to the front. The property is ideally situated within easy reach of local schools, shops, public transport links, and scenic walking routes, making day-to-day life convenient and enjoyable.

Combining a peaceful setting with modern living, this charming home is ready to move into. Early viewing is highly recommended to avoid disappointment.

Council Tax Band: B

Tenure: Freehold

Price: Offers Over £145,000

Property Type: Semi-detached house

Parking: Driveway

Construction materials: Brick and block

Heating: Gas

## Front External

Compsite door, drive with gated access to rear garden



## Entry hall

Doors leading to kitchen/ lounge area and downstairs w.c

## Downstairs w.c

1.55m x 1.52m (5'1" x 4'11")

w.c/ radiator and wash basin



## Kitchen/ Lounge

4.16m x 7.49m (13'7" x 24'6")

The open-plan kitchen/lounge features modern wall and base units with worktops, a built-in electric oven, gas hob with extractor, and a stainless steel sink with mixer tap. There's plumbing for a washing machine and dishwasher. The lounge includes a wall-mounted electric fire, TV and telephone points, under-stairs storage, and French doors leading to the rear garden. The space benefits from double glazed windows to both the front and rear aspects, laminate flooring, and a central heating radiator.



## Lounge



## Landing

Doors leading to both bedrooms

## Bedroom One

3.40m x 2.72m (11'1" x 8'11")

A range of fitted wardrobes, an additional storage cupboard, two radiators, access to the en-suite, and French doors opening onto a Juliet balcony.



## En-suite

1.94m x 1.54m (6'4" x 5'0")

Fitted with a mains-fed shower, pedestal wash basin, W.C., and fully tiled walls.



## Bedroom Two

3.04m x 2.92m (9'11" x 9'6")

Includes a built-in storage cupboard, laminate flooring, and a central heating radiator, access to en-suite



## En-suite Two

1.55m x 1.52m (5'1" x 4'11")

Features a corner shower cubicle with a mains-fed shower, pedestal wash basin, W.C., and a central heating radiator.



## Rear External

An enclosed gravelled garden complete with a paved patio area and garden shed.





Floor 0

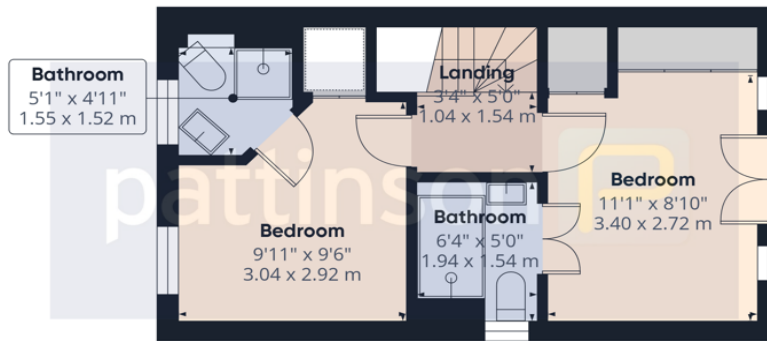

Floor 1

Approximate total area<sup>®</sup>  
600 ft<sup>2</sup>  
55.7 m<sup>2</sup>

(1) Excluding balconies and terraces

Calculations reference the RICS IPMS 3C standard. Measurements are approximate and not to scale. This floor plan is intended for illustration only.

GIRAFFE360

Energy Efficiency Rating		Current	Potential
<i>Very energy efficient - lower running costs</i>			
(92-100) <b>A</b>			
(81-91) <b>B</b>			89
(69-80) <b>C</b>		75	
(55-68) <b>D</b>			
(39-54) <b>E</b>			
(21-38) <b>F</b>			
(1-20) <b>G</b>			
<i>Not energy efficient - higher running costs</i>			
<b>England, Scotland &amp; Wales</b>		EU Directive 2002/91/EC	

Horton Close, Consett, Durham, DH8 7EN

Contact your local branch today for more information on this property:

**126A Trinity Street, Huddersfield, West Yorkshire, HD1 4DT, Tel: 01484 506211, admin@yellowbrickroadestateagents.co.uk, www.ybrea.co.uk**

These particulars, whilst believed to be accurate are set out as a general outline only for guidance and do not constitute any part of an offer or contract. Intending purchasers should not rely on them as statements of representation of fact, but must satisfy themselves by inspection or otherwise as to their accuracy. No person in this firm's employment has the authority to make or give any representation or warranty in respect of the property.

